

WCU Shuttles

Green Route

Monday-Thursday: 8:30 AM - 6:00 PM

Friday: 8:30 AM - 4:00 PM



Map showing the Blue Route shuttle path with labeled stops across campus. The route loops through key locations, with marked pickup points.

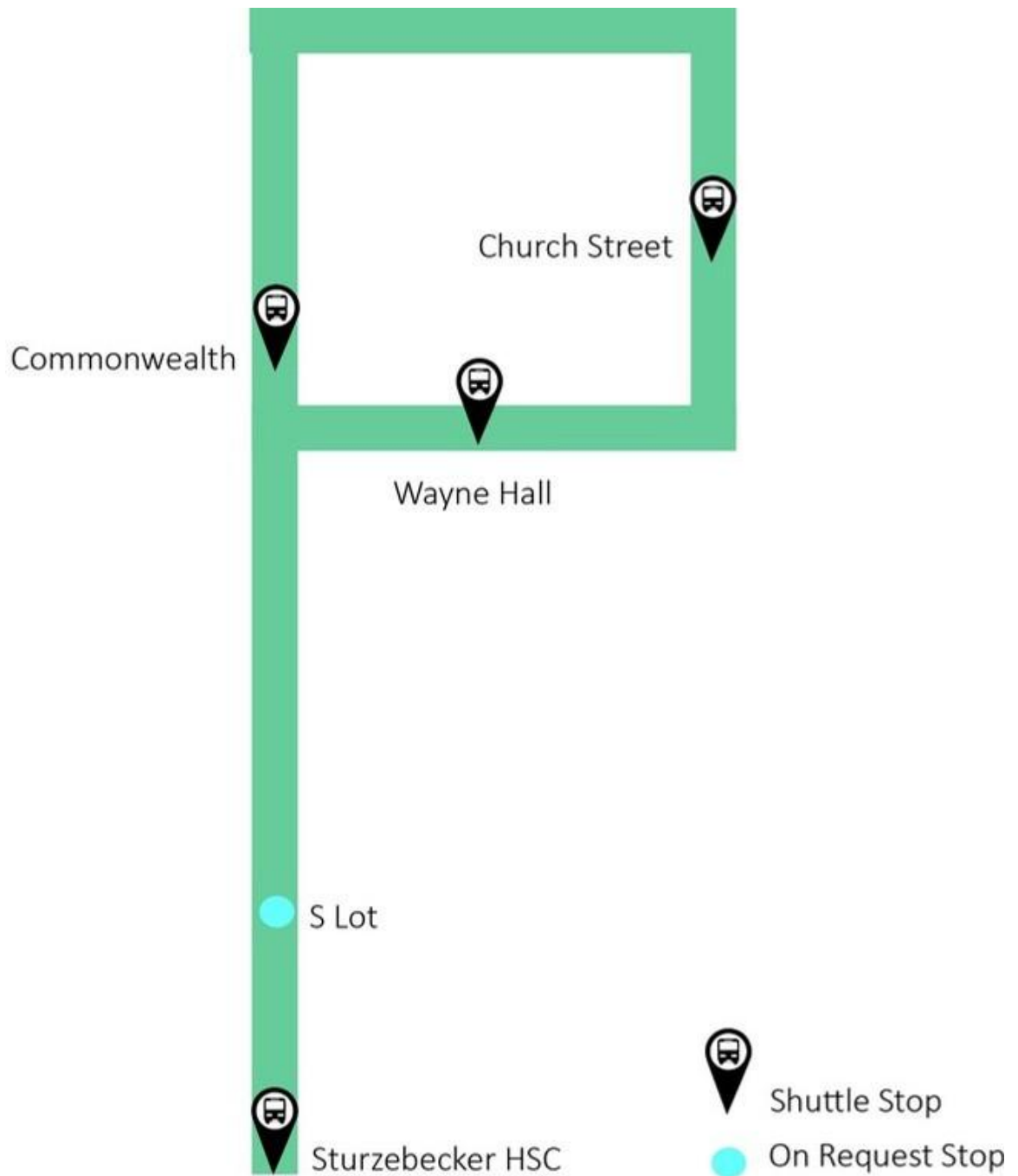

GREEN ROUTE

Monday-Thursday

BLOCK	NORTHBOUND			SOUTHBOUND		
	HSC	Commonwealth Hall	ARRIVE Church St.	LEAVE Church St.	Wayne Hall	HSC
F				8:30	8:32	8:37
F	8:39	8:43	8:46	8:49	8:51	8:55
F	8:57	9:01	9:04	9:07	9:09	9:13
G				9:16	9:18	9:22
F	9:15	9:19	9:22	9:25	9:27	9:31
G	9:24	9:28	9:31	9:34	9:36	9:40
F	9:33	9:37	9:40	9:43	9:45	9:49
G	9:42	9:46	9:49	9:52	9:54	9:58
F	9:51	9:55	9:58	10:01	10:03	10:07
G	10:00	10:04	10:07	10:10	10:12	10:16
F	10:09	10:13	10:16	10:19	10:21	10:25
G	10:18	10:22	10:25	10:28	10:30	10:34
F	10:27	10:31	10:34	10:37	10:39	10:43
G	10:36	10:40	10:43	10:46	10:48	10:52
F	10:45	10:49	10:52	10:55	10:57	11:01
G	10:54	10:58	11:01	11:04	11:06	11:10
F	11:03	11:07	11:10	11:13	11:15	11:19
G	11:12	11:16	11:19	11:22	11:24	11:28
F	11:21	11:25	11:28	11:31	11:33	11:37
G	11:30	11:34	11:37	11:40	11:42	11:46
F	11:39	11:43	11:46	11:49	11:51	11:55
G	11:48	11:52	11:55	11:58	12:00	12:04
F	11:57	12:01	12:04	12:07	12:09	12:13
G	12:06	12:10	12:13	12:16	12:18	12:22
F	12:15	12:19	12:22	12:25	12:27	12:31
G	12:24	12:28	12:31	12:34	12:36	12:40

F	12:33	12:37	12:40	12:43	12:45	12:49
G	12:42	12:46	12:49	12:52	12:54	12:58
F	12:51	12:55	12:58	13:01	13:03	13:07
G	13:00	13:04	13:07	13:10	13:12	13:16
F	13:09	13:13	13:16	13:19	13:21	13:25
G	13:18	13:22	13:25	13:28	13:30	13:34
F	13:27	13:31	13:34	13:37	13:39	13:43
F	13:45	13:49	13:52	13:55	13:57	14:01
F	14:03	14:07	14:10	14:13	14:15	14:19
F	14:21	14:25	14:28	14:31	14:33	14:37
F	14:39	14:43	14:46	14:49	14:51	14:55
F	14:57	15:01	15:04	15:07	15:09	15:13
F	15:15	15:19	15:22	15:25	15:27	15:31
F	15:33	15:37	15:40	15:43	15:45	15:49
F	15:51	15:55	15:58	16:01	16:03	16:07
F	16:09	16:13	16:16	16:19	16:21	16:25
F	16:27	16:31	16:34	16:37	16:39	16:43
F	16:45	16:49	16:52	16:55	16:57	17:01
F	17:03	17:07	17:10	17:13	17:15	17:19
F	17:21	17:25	17:28	17:31	17:33	17:37
F	17:39	17:43	17:46	17:49	17:51	17:55

GREEN ROUTE

Friday

BLOCK	NORTHBOUND			SOUTHBOUND		
	HSC	Commonwealth Hall	ARRIVE Church St.	LEAVE Church St.	Wayne Hall	HSC
F				8:30	8:32	8:37
F	8:39	8:43	8:46	8:49	8:51	8:55
F	8:57	9:01	9:04	9:07	9:09	9:13
G				9:16	9:18	9:22
F	9:15	9:19	9:22	9:25	9:27	9:31
G	9:24	9:28	9:31	9:34	9:36	9:40
F	9:33	9:37	9:40	9:43	9:45	9:49
G	9:42	9:46	9:49	9:52	9:54	9:58
F	9:51	9:55	9:58	10:01	10:03	10:07
G	10:00	10:04	10:07	10:10	10:12	10:16
F	10:09	10:13	10:16	10:19	10:21	10:25
G	10:18	10:22	10:25	10:28	10:30	10:34
F	10:27	10:31	10:34	10:37	10:39	10:43
G	10:36	10:40	10:43	10:46	10:48	10:52
F	10:45	10:49	10:52	10:55	10:57	11:01
G	10:54	10:58	11:01	11:04	11:06	11:10
F	11:03	11:07	11:10	11:13	11:15	11:19
G	11:12	11:16	11:19	11:22	11:24	11:28
F	11:21	11:25	11:28	11:31	11:33	11:37
G	11:30	11:34	11:37	11:40	11:42	11:46
F	11:39	11:43	11:46	11:49	11:51	11:55
G	11:48	11:52	11:55	11:58	12:00	12:04
F	11:57	12:01	12:04	12:07	12:09	12:13
G	12:06	12:10	12:13	12:16	12:18	12:22
F	12:15	12:19	12:22	12:25	12:27	12:31
G	12:24	12:28	12:31	12:34	12:36	12:40

F	12:33	12:37	12:40	12:43	12:45	12:49
G	12:42	12:46	12:49	12:52	12:54	12:58
F	12:51	12:55	12:58	13:01	13:03	13:07
G	13:00	13:04	13:07	13:10	13:12	13:16
F	13:09	13:13	13:16	13:19	13:21	13:25
G	13:18	13:22	13:25	13:28	13:30	13:34
F	13:27	13:31	13:34	13:37	13:39	13:43
F	13:45	13:49	13:52	13:55	13:57	14:01
F	14:03	14:07	14:10	14:13	14:15	14:19
F	14:21	14:25	14:28	14:31	14:33	14:37
F	14:39	14:43	14:46	14:49	14:51	14:55
F	14:57	15:01	15:04	15:07	15:09	15:13
F	15:15	15:19	15:22	15:25	15:27	15:31
F	15:33	15:37	15:40	15:43	15:45	15:49

GREEN ROUTE

NORTH CAMPUS

SOUTH CAMPUS

- | | | |
|--------------------------|--------------------------|---------------------------|
| STUDENT SERVICES | STUDENT HOUSING | ACADEMIC BUILDINGS |
| 1 Sykes Student Union | 1. Tyson | 12. BPMC |
| 2 FHG Library | 2. Goshen | 13. Mitchell |
| 3 Peoples | 3. Schmidt | 14. 25 University Ave. |
| 4 Student Rec Center | 4. Killinger | 15. Ruby Jones Hall |
| 5 Lawrence Center | 5. Brandywine Hall | 16. SECC |
| 6 University Post Office | 6. Allegheny Hall | 17. Ehinger/Hollinger |
| | 7. Commonwealth Hall | 18. Science Complex |
| | 8. University Hall | 19. Anderson Hall |
| | 9. College Arms Apts. | 20. Old Library |
| | 10. South Campus Apts. | 21. Recitation Hall |
| | 11. Village Campus Apts. | 22. Main Hall |
| | | 23. E.O. Bull |
| | | 24. Swope |
| | | 25. 210 E. Rosedale |
| | | 26. Sturzebecker HSC |

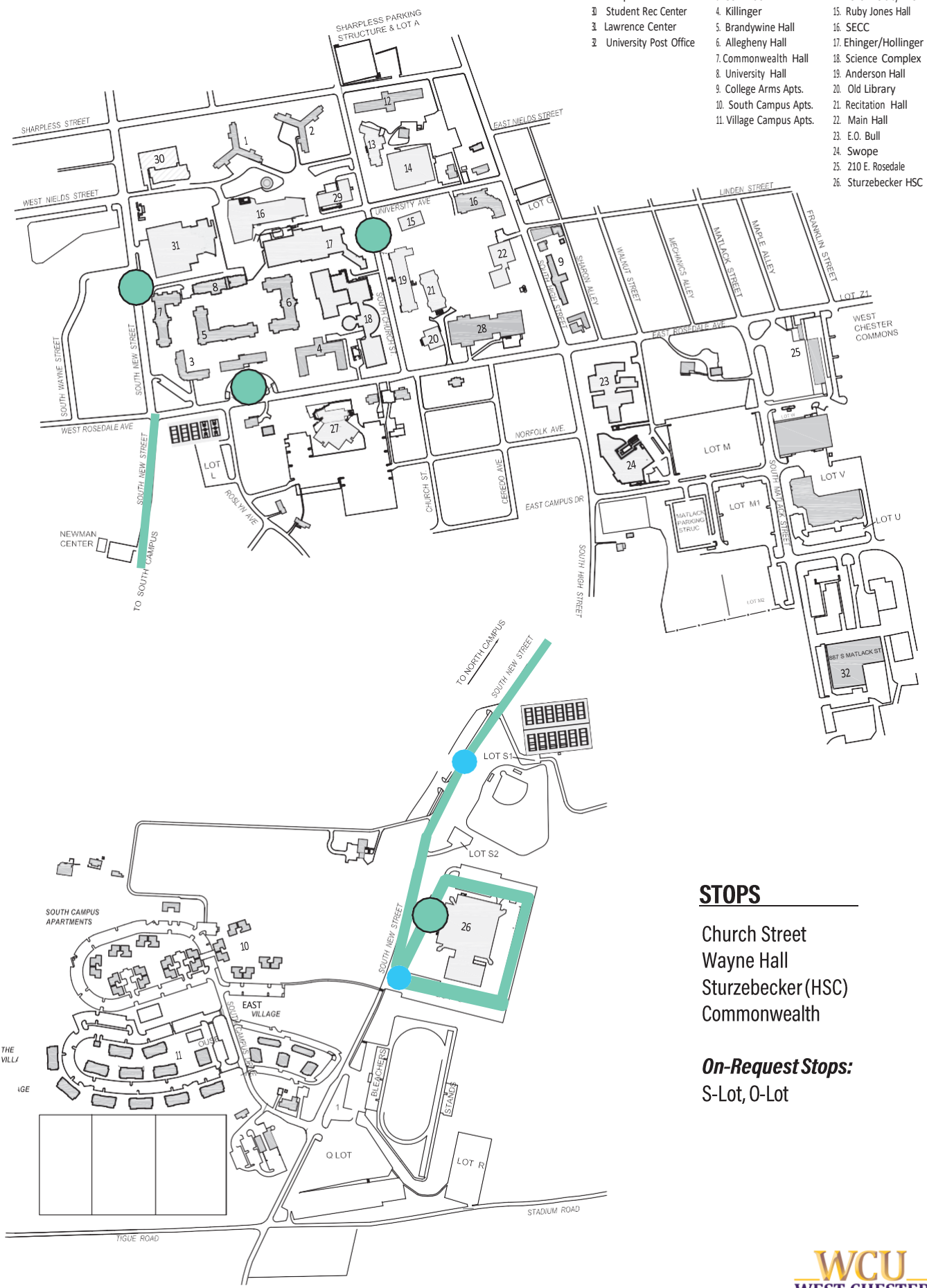

STOPS

- Church Street
- Wayne Hall
- Sturzebecker (HSC)
- Commonwealth

On-Request Stops:

- S-Lot, O-Lot

